

ERGOCUT A 141

CE EN60974-7



CODE	↔		
PAA306M-000-BA3	6 m	19.7'	1/4 GAS
PAA306M-082-BA3	6 m	19.7'	M14x1
PAA306M-004-BA3	6 m	19.7'	CENTRAL 004
PAA306M-304-BA3	6 m	19.7'	TRAFIMECTOR® 304

TECHNICAL DATA		
HF	ERGOCUT A 141	
1 m	1,1 kg	2.43 lb
V PEAK	500	
5 bar	5 bar	
210 l/min	210 l/min	
X 60%	140A	
X 100%	100A	
35-40 mm	35-40 mm	1"3/8-1"9/16

For Central 004 and Trafimector 304 pin connection scheme see page 114

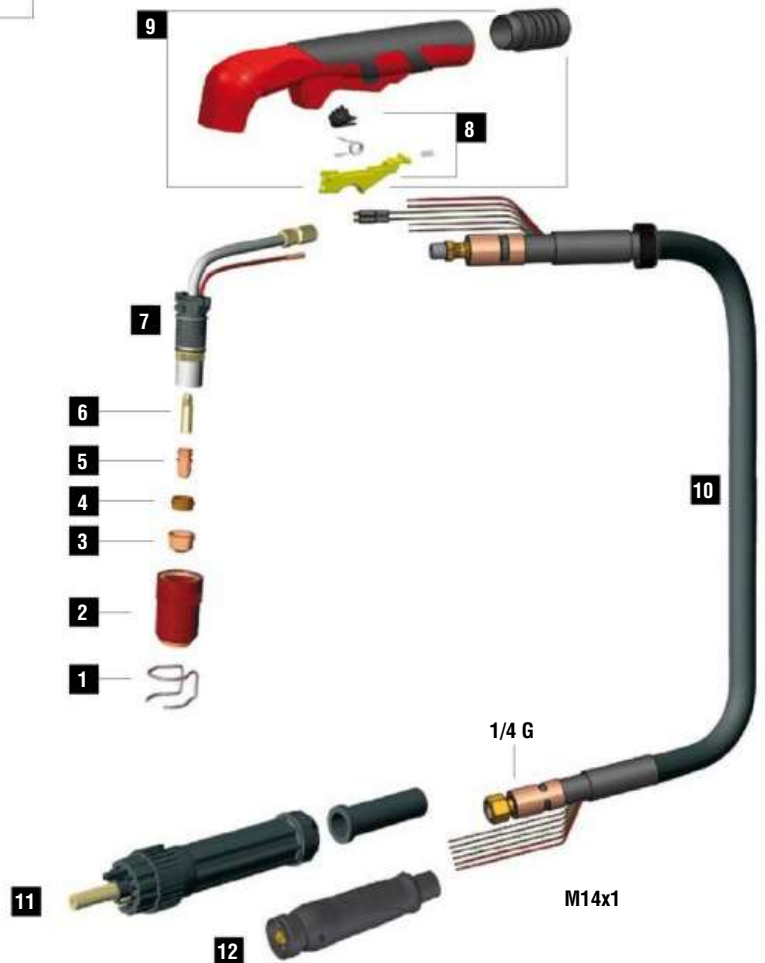
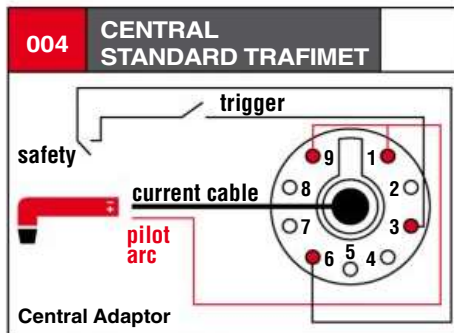

	CODE		Description	Ø	↔	CONTACT		DRAG		GOUGING	REF			
1	CV0008		stand off guide		32,5 mm		●				51957	10		
1	CV0009		stand off guide		38,6 mm				●			10		
1	CV0011		stand off guide		23 mm	●					1386	10		
1	CV0012		stand off guide		30 mm	●					1408	2		
1	CV0013		stand off guide		33 mm					●	1406	2		
1	CV0014		stand off guide		30 mm	●						2		
1	CV0021		stand off guide	32,8 mm	40,6 mm	●						1		
1	CV0023		stand off guide		17,6 mm					●		10		
1	CV0039		stand off guide		18,5 mm	●						2		
2	FH0297		insulator for CV0039/ CV0023			●				●		10		
2	PC0101		nozzle		52,1 mm	●				●		2		
2	PC0102		long life nozzle		52,1 mm	●				●		2		
2	PC0103		nozzle		50,3 mm		●		●			2		
2	PC0131		long life		50,9 mm	●	●		●	●		2		
3	PD0101-08		30 A	0,8 mm	.030"	13,7 mm	●	●				-	10	
3	PD0101-11		60 A	1,1 mm	.043"	13,7 mm	●	●					-	10
3	PD0101-14		100 A	1,4 mm	.055"	13,7 mm	●	●					-	10
3	PD0101-17		130 A	1,7 mm	.066"	13,7 mm	●	●					-	10
3	PD0101-19		140 A	1,9 mm	.075"	13,7 mm	●	●					-	10
3	PD0101-30		gouging tip	3,0 mm	1/8"	13,7 mm					●	●		-
3	PD0111-12		80 A	1,2 mm	.047"	35,8 mm		●					-	10
3	PD0117-14		100 A	1,4 mm	.055"	34,8 mm				●			-	10
3	PD0117-17		130 A	1,7 mm	.066"	34,8 mm				●			-	10
3	PD0117-19		140 A	1,9 mm	.075"	34,8 mm				●			-	10
4	PE0101		diffuser		7,8 mm	●	●			●	●		-	2
4	PE0103		diffuser		7,8 mm	●	●	●		●	●		-	2
5	PR0101		electrode		22 mm	7/8"	●	●			●	●		10
5	PR0116		electrode		43,1 mm			●		●				10
6	FH0563		air tube		29 mm	●	●			●	●		1	

	CODE		Description	
7	EA0131		O-ring Ø 19x2 mm	10
7	PF0155		Ergocut A 141 torch head	1
8	TP0400		trigger kit	1
9	TP0402		handle kit	1
10	PH4020		coaxial cable - 6 m / 19.7' - M14X1 (no pin)	1
10	PH4023		coaxial cable - 6 m / 19.7' - 1/4 G (no pin)	1

	CODE		Description	
11	BW0147		cable support	10
11	FY0023		plasma central adaptor - 5 pins	1
12	FY0090		TRAFIMECTOR® central adaptor - torch side	1
	EA0254		pin extractor for central adaptor	1
	PT0202		male spring pins kit (5 pcs)	1

STANDARD

CONTACT SHORT CONTACT LONG DRAG SHORT DRAG LONG GOUGING